

Dispute Resolution & Counseling | Graduate Liberal Studies | Education Policy & Leadership
Teaching & Learning | Applied Physiology & Wellness

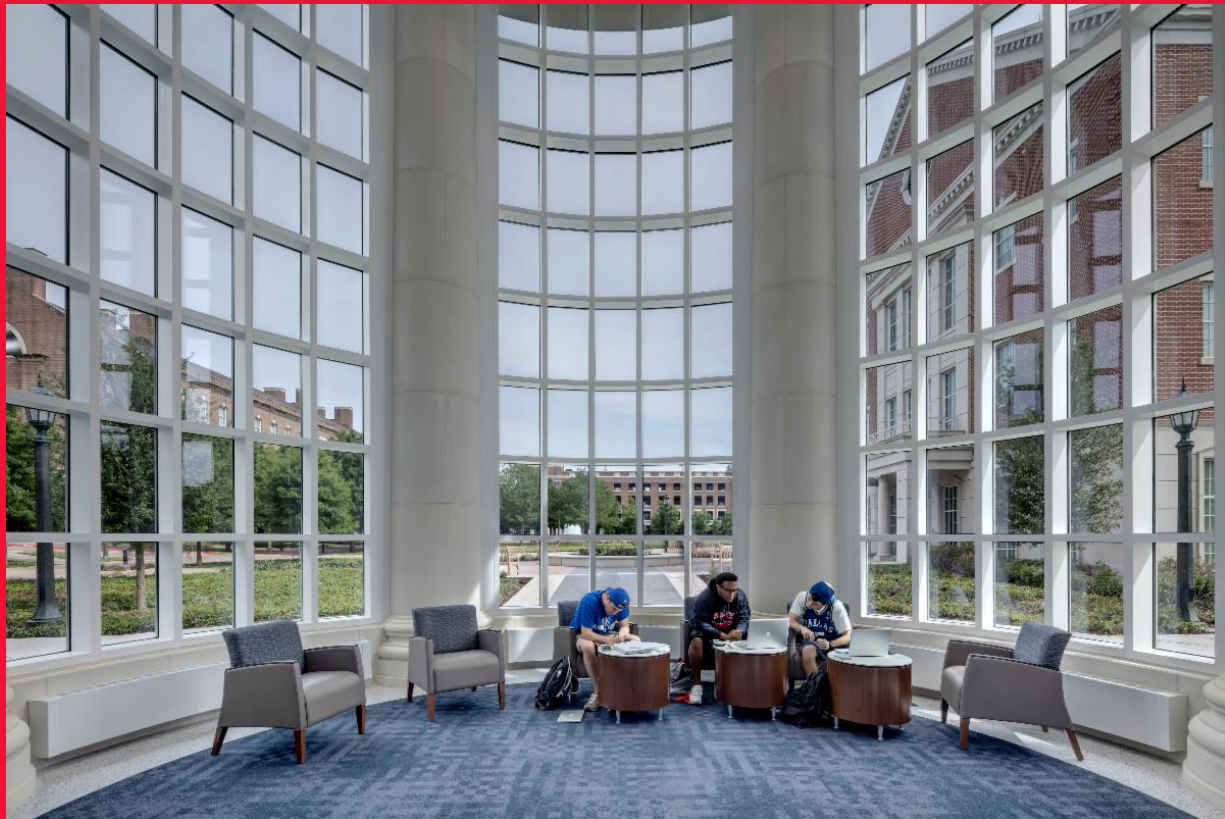

MOVING FORWARD | THE DEAN'S VIEW

SMU Simmons Continues to Rise in *U.S. News & World Report* Rankings: No. 15 in Best Private Graduate Schools in Education



SMU's Simmons School of Education and Human Development solves problems through research, framed by the highest standards of inquiry and defined by collaboration across fields. Our latest ranking in *U.S. News and World Report* reflects this strength.

We are on an upward trajectory. Last year, we ranked 63, which was a big leap from the prior 105. This year, we advanced four more points to No. 59. Simmons moved up to the top 15 education schools at national private universities, and first in Texas private schools of education.

I am delighted that as a young school of education, we remain nationally competitive in research, teaching, and learning. However, it is the context of what we do that makes me the proudest because it all comes back to improving the lives of children and families. This is where we matter the most.

COVID-19 made educators, students, and families reconfigure and adapt to new classroom

experiences. Some outcomes were successful but others not, so we need to grapple with how we improve teaching and learning.

Though the pandemic is still with us, we can envision life differently. The horizon is clearer because we can see what is working to get us back on track. Vaccines—no small feat of science and technology-- are on the rise, classroom protocols are in place, and hope continues to grow.

As we move ahead, we truly must keep our eyes on evidence-based practices to help our students. They and their families are depending on us.



Stephanie L. Knight
Leon Simmons Endowed Dean

Onward. Upward. Always.

The Simmons School of Education and Human Development is changing minds – and challenging the way we think. As a transformative leader, our commitment to rigorous, research-driven programs promotes evidence-based, effective practices and policy. Fresh thinking and breakthrough research will drive meaningful change in the fields of education and human development.

STAY IN THE KNOW
smu.edu/ChangingMinds



© Southern Methodist University | Dallas TX 75205 | 214-768-2000

[View this email in your browser](#)

Want to change how you receive these emails?
Click Update Profile below